

EAST SIDE ELEVATION

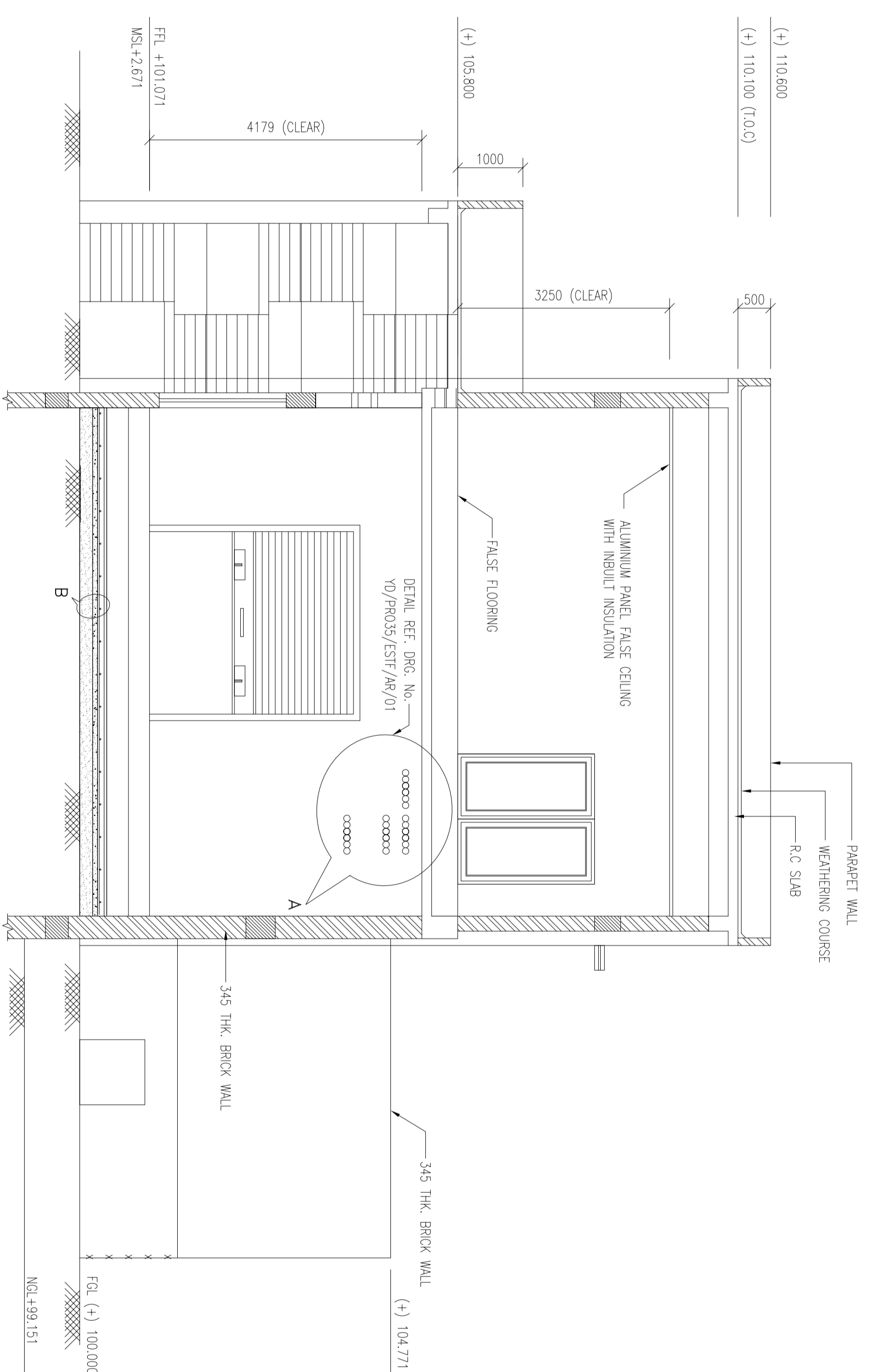

SECTION 1-1

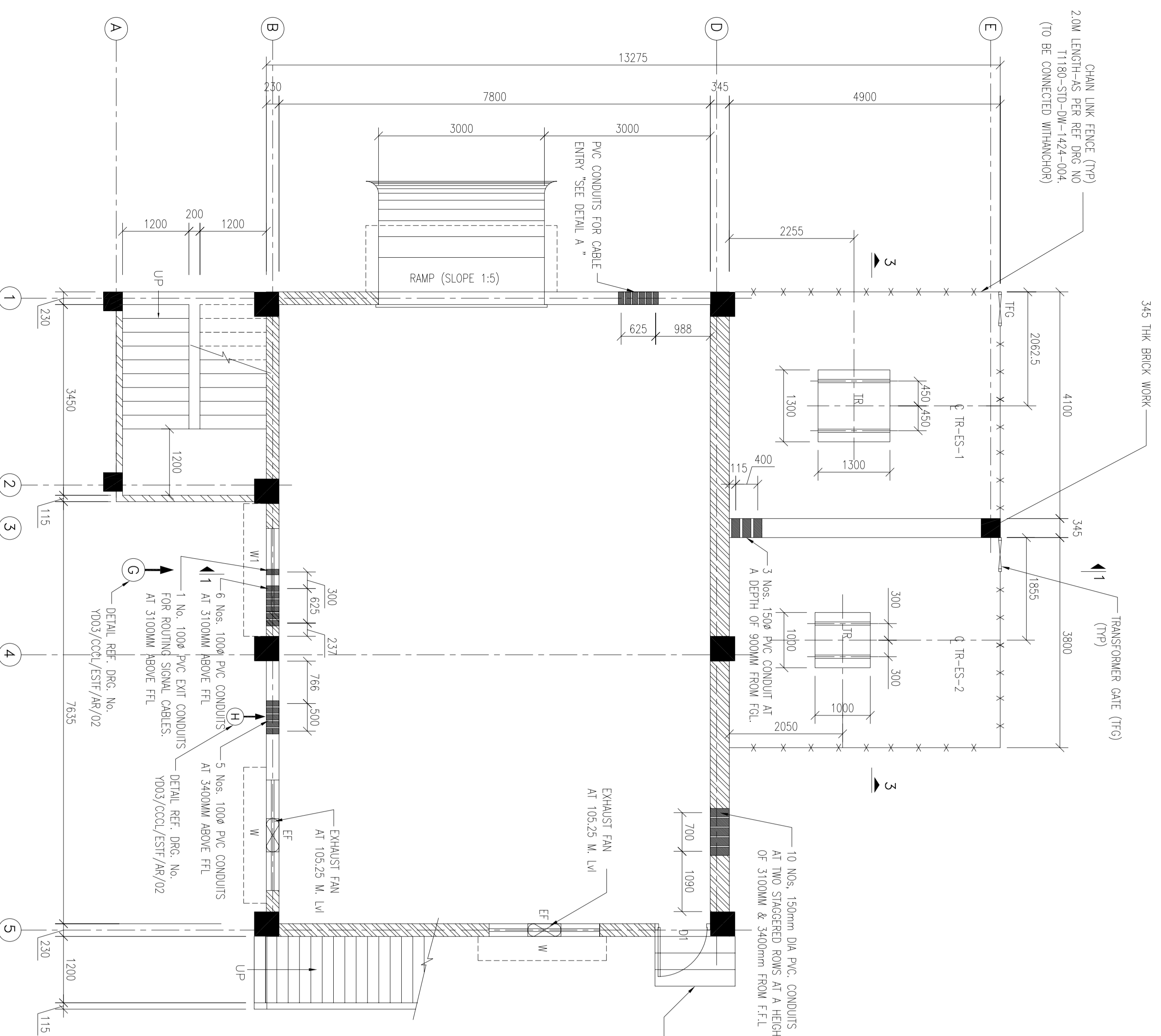

GROUND FLOOR PLAN

FLL (+) 101.071
(TOP INSERT PLATE EL(+)) 101.071

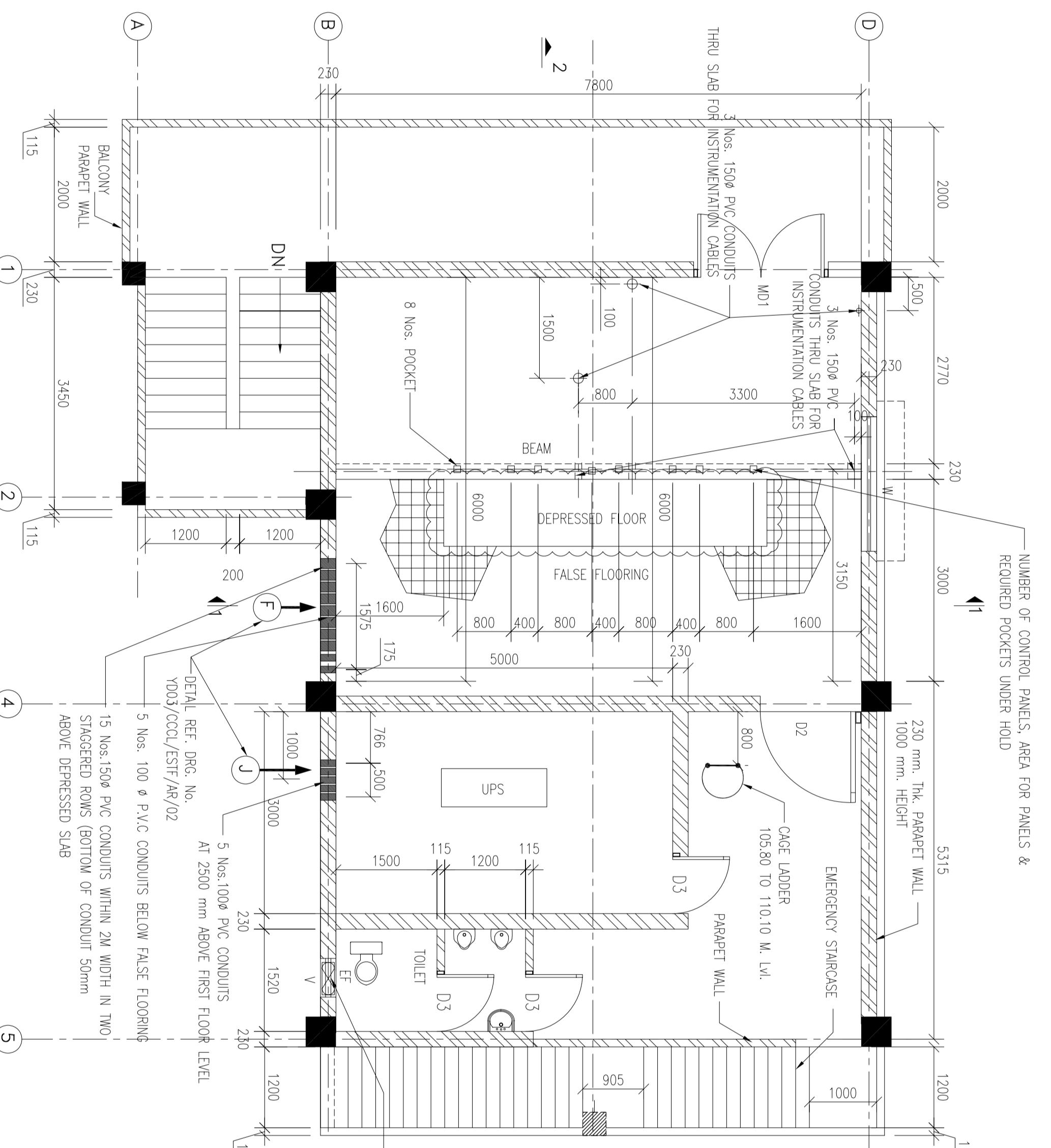

FIRST FLOOR PLAN

TOC (+) 105.800

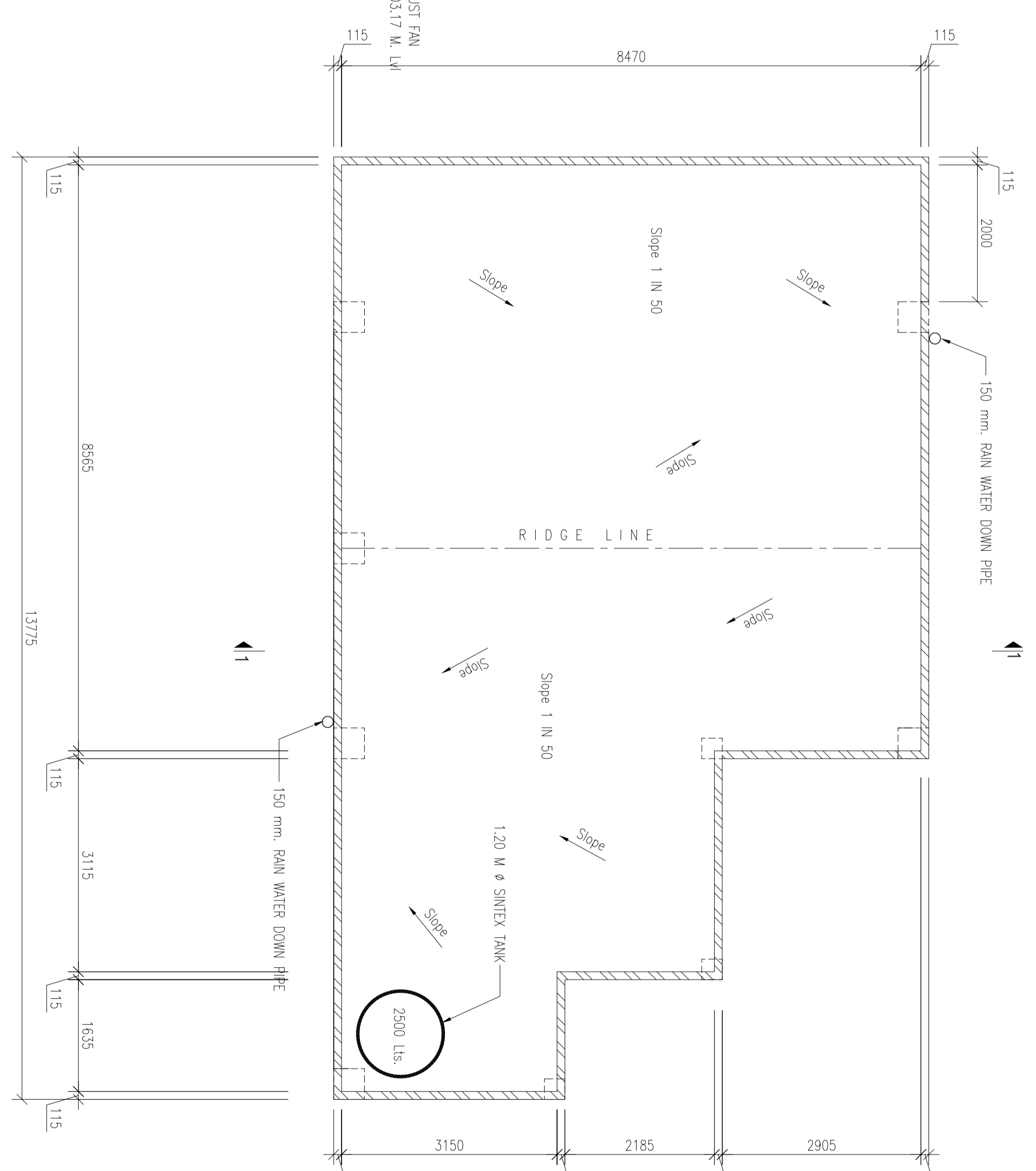

TERRACE FLOOR PLAN

TOC (+) 110.100

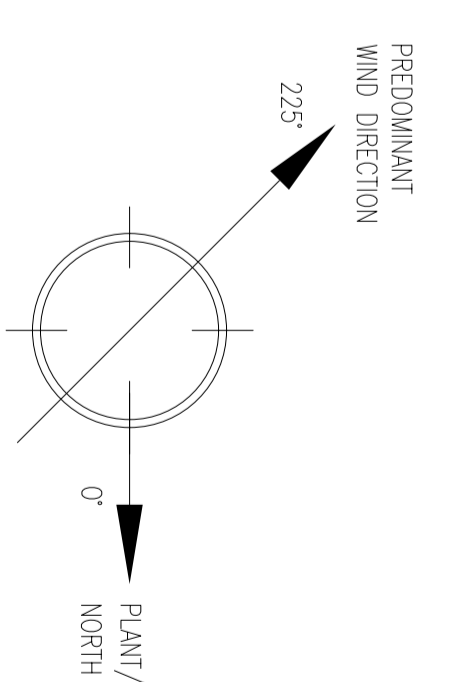

- NOTES:-
1. ALL DIMENSIONS ARE IN MM & LEVEL ARE IN METERS
 2. 230mm BRICK WORK IN CM 1:6 UNLTD
 3. BRICKS SHALL BE OF CLASS DESIGNATION 75
 4. INTERNAL WALL PLASTERING IN CM 1:6 1:2 mm THK.
 5. EXTERNAL WALL PLASTERING IN CM 1:6 1:8 mm THK.
 6. ALL COLUMNS, BEAMS, SLABS, RCC PROTECTION CHALKA, SUNSHADE ETC SHALL BE PLASTERED WITH 12 mm THK. CEMENT MORTAR.
 7. ALL EXTERNAL WALLS COLUMNS PROTECTION, RCC BEAMS, FINIS, ROOF PROTECTION ETC. SHALL HAVE 18mm THK. SAND FACED PLASTER IN 1:6 CEMENT MORTAR
 8. CEILING SHALL BE WHITE WASHED WITH THREE COATS AS PER IS: 6728
 9. ALL INTERNAL WALL PAINTED WITH TWO COATS OF OBO/ACRYLIC EMULSION AS IN TABLE
 10. ALL EXTERNAL WALL PAINTED WITH TWO COATS CEMENT WATER PROOF PAINT OVER PRIMAING AS PER IS: 5410
 11. RECONSTRUCTIONAL ANTI-TERMITE TREATMENT AS PER IS: 8944 AND IS: 6313 SHALL BE PROVIDED AS PER IS: 5410
 12. CONCRETE GRADE SHALL BE M20 REINFORCEMENT STEEL SHALL BE TISSON GR6 F4 415 CONFORMING TO IS 1786 AND COATING AS PER IS: 11820
 13. ALL ROOMS SHALL HAVE 125 mm HIGH SKIRTING OF CORRESPONDING FLOOR FINISH
 14. ROLLING SHUTTERS - FINISH WITH TWO COATS OF SYNTHETIC EMULS PAINT OVER A COAT OF PRIMER AS PER IS: 3537 ALL FLUSH DOORS TO BE PAINTED WITH TWO COATS OF REDDY WAX PAINT-CONFORMING TO IS OVER PRIMER COAT WOOD PRIMER AS PER IS: 3536
 15. SEPTIC TANK & SOAK PIT FOR TOILET WATER (FOR 20 PERSONS) TO BE PROVIDED
 16. PROVISION FOR AC WINDOW IN CONTROL ROOM & UPS TO BE DONE
 17. ROOMS WIDE PLASTER PROTECTION ALL AROUND BUILDING TO BE PROVIDED
 18. DOORS SHALL HAVE 63 mm THK. LAMINATED GLASS & WINDOWS 10mm THK. LAMINATED GLASS
 19. CONTROL ROOM SHALL HAVE ALUMINIUM PANEL, FALSE CEILING, (CLEAR HEIGHT 2250) AND UPS ROOM SHALL HAVE 20mm THK. RHEINOC FLOOR (UP TO 20KV) UNDER ROCK INSULATION
 20. PROVISIONS FOR CONCEALED WIRING SHALL BE MADE FOR CONTROL ROOM ONLY
 21. ALL OVERHEAD (UNLTD WAKE) WIRE OF CAPACITY 2.5M² TO BE PROVIDED WITH
 22. TRANSFORMERS ARE INSTALLED IN OPEN SPACES (NO SUN ROOF)
 23. FOR LOADS & DETAILS OF TRANSFORMER FOUNDATIONS SET UNDER DRG. Nos. 410-11171/A, 410-11172/A
 24. ALL INSERT PLATES ARE 10mm THK.
 25. PARAPET WALLS & MOAT SHALL BE CONSTRUCTED AFTER ENTRY OF CONTROL PANELS INSIDE CONTROL ROOM

SCHEDULE FOR WALL & FLOOR FINISHES

| S.NO. | ROOM DETAILS | WALL FINISHES | FLOOR FINISHES |
|-------|-------------------------|--|--|
| 1. | SUB STATION | OBO/ACRYLIC EMULSION PAINT-2 COATS OVER PRIMER | AS IN DETAIL - B |
| 2. | CONTROL ROOM & UPS ROOM | OBO/ACRYLIC EMULSION PAINT-2 COATS OVER PRIMER | 40 mm THK. TILING OF M15 FROM THE WATER TIGHTED TILES (CEILING) WITH FINISH NON SPO (UP TO 230 KV HEIGHT WITH 150mm THK. CM 1:6) |
| 3. | TOILET BLOCK | OBO 2 COAT PRIMAING COAT | KOTA STONE FLOORING OVER 20mm THK. CM 1:6 |
| 4. | CORRIDOR | OBO 2 COAT PRIMAING COAT | KOTA STONE FLOORING OVER 20mm THK. CM 1:6 |
| 5. | MAIN STAIRCASE | OBO 2 COAT PRIMAING COAT | KOTA STONE FLOORING OVER 20mm THK. CM 1:6 |
| 6. | EMERGENCY STAIRCASE | OBO 2 COAT PRIMAING COAT | BRICK WORK & PLASTERING |
| 7. | RAMPS | - | 40mm THK. C.C. FLOORING OF M20 |

JONERRY SCHEDULE

| S.NO. | TYPE | DESCRIPTION | SIZE W x H | Nos. | DETAILS |
|-------|------|-------------------------|-------------|------|--|
| 1. | RS | MANUAL ROLLING SHUTTER | 3000 x 3000 | 1 | 100RSRS TO HAVE RARELY HEAVY COIL IN THE ZONE BETWEEN 1.0 M. TO 2.50 M FROM BOTTOM |
| 2. | MOI | ALUMINIUM DOOR | 2000 x 2100 | 1 | BOTTOM OF LAMINATED GLASSERS WITH 20mm THK. CM 1:6 |
| 3. | D1 | ALUMINIUM PANELLED DOOR | 1000 x 2100 | 1 | - DO - |
| 4. | D2 | SOLID FLUSH DOOR | 1500 x 2100 | 1 | - DO - |
| 5. | D3 | SOLID FLUSH DOOR | 900 x 2100 | 2 | - DO - |
| 6. | D4 | SOLID FLUSH DOOR | 750 x 2100 | 2 | WAKE PUT PANELS |
| 7. | W | ALUMINIUM WINDOW | 2000 x 1950 | 3 | WITH SLABS |
| 8. | W1 | ALUMINIUM WINDOW | 1500 x 1950 | 1 | WITH SLABS |
| 9. | EF | EXHAUST FAN | 400 x 400 | 3 | WITH SLABS |
| 10. | TFC | TRANSFORMER DATE | 900 x 2000 | 2 | - |
| 11. | V | VENTILATOR | 750 x 600 | 1 | - |

APPROVED BY TECHNICAL

| S.NO. | REV. | DATE | DESCRIPTION | SIGN |
|-------|------|----------|---|------|
| 1. | R0 | 18-05-05 | ISSUED FOR APPROVAL | |
| 2. | R1 | 31-05-05 | REVISED AS PER YOUR COMMENT DT-27-05-05 | |

PROJECT:-
ETHYLENE STORAGE TERMINAL FACILITY
AT KARAIKAL

CLIENT:-
TECHNIP INDIA

TURKKEY CONTRACTORS:-

CONSOLIDATED CONSTRUCTION CONSORTIUM LTD
#5 2nd LINK STREET,CIT COLONY
MYPAPORE, CHENNAI 600 004

STRUCTURAL CONSULTANTS:-

YUGASOPT - DESIGN DEPARTMENT
#13, WEST SWAMI KOIL STREET
VADAPALANI, CHENNAI - 26

TITLE:-
SUB STATION & CONTROL ROOM
PLAN, SECTIONS, ELEVATION & DETAILS

| DESIGNED | AS | APPROVED | KMD | SCALE | 1:100 | REV | RI |
|----------|---------|----------|------|----------|-------|-----|----|
| MANI | CHECKED | RSR | DATE | 18-05-05 | | | |
| DESIGNED | AS | APPROVED | KMD | SCALE | 1:100 | REV | RI |

DRG.NO. YD/PRO35 / ESTP / AR / 01